

# Configurar o ISE 2.3 Facebook Social Media para portais de convidados

## Contents

[Introduction](#)

[Prerequisites](#)

[Requirements](#)

[Componentes Utilizados](#)

[Diagrama de Rede](#)

[Configuração](#)

[1. Configurar aplicativo do Facebook](#)

[2. Integrar o ISE ao aplicativo do Facebook](#)

[3. Configurar políticas de autenticação e autorização](#)

[Verificar](#)

[Troubleshoot](#)

[Depurações no ISE](#)

## Introduction

Este documento descreve como configurar a integração do Cisco Identity Services Engine (ISE) 2.3 com credenciais do Facebook para acesso de convidado autenticado.

## Prerequisites

### Requirements

A Cisco recomenda que você tenha conhecimento destes tópicos:

- Configuração do Identity Services Engine (ISE)
- Configuração básica do aplicativo do Facebook

### Componentes Utilizados

As informações neste documento são baseadas nestas versões de software e hardware:

- Cisco ISE versão 2.3
- Login social do Facebook
- Cisco Wireless LAN Controller (WLC) versão 8.3.102.0

The information in this document was created from the devices in a specific lab environment. All of the devices used in this document started with a cleared (default) configuration. If your network is live, make sure that you understand the potential impact of any command.

### Diagrama de Rede

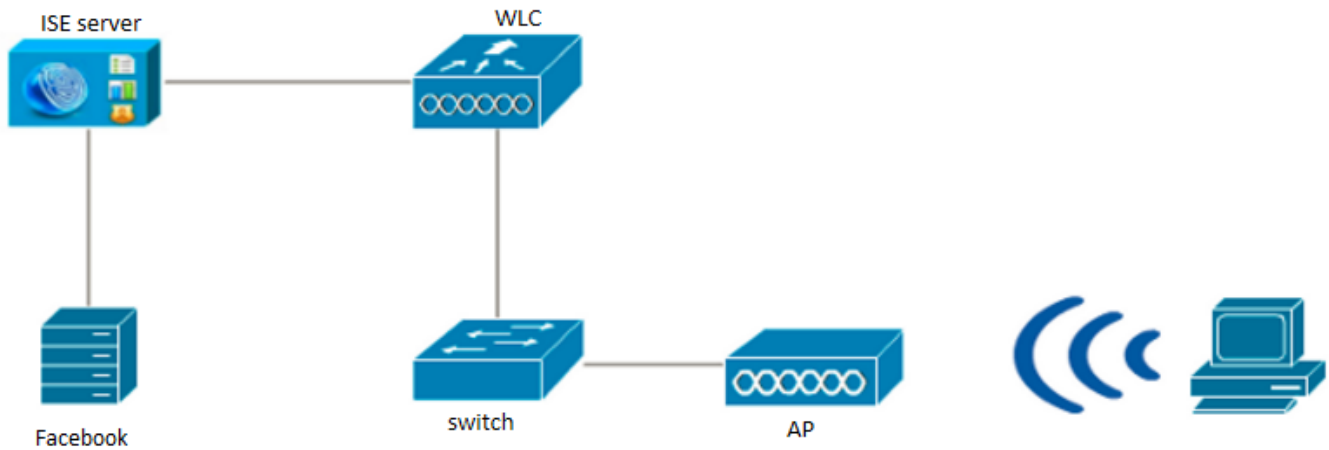

## Configuração

A configuração do aplicativo Facebook apresentada é um exemplo e não uma configuração recomendada pela Cisco.

### 1. Configurar aplicativo do Facebook

Vá para <https://developers.facebook.com> e registre o novo aplicativo.

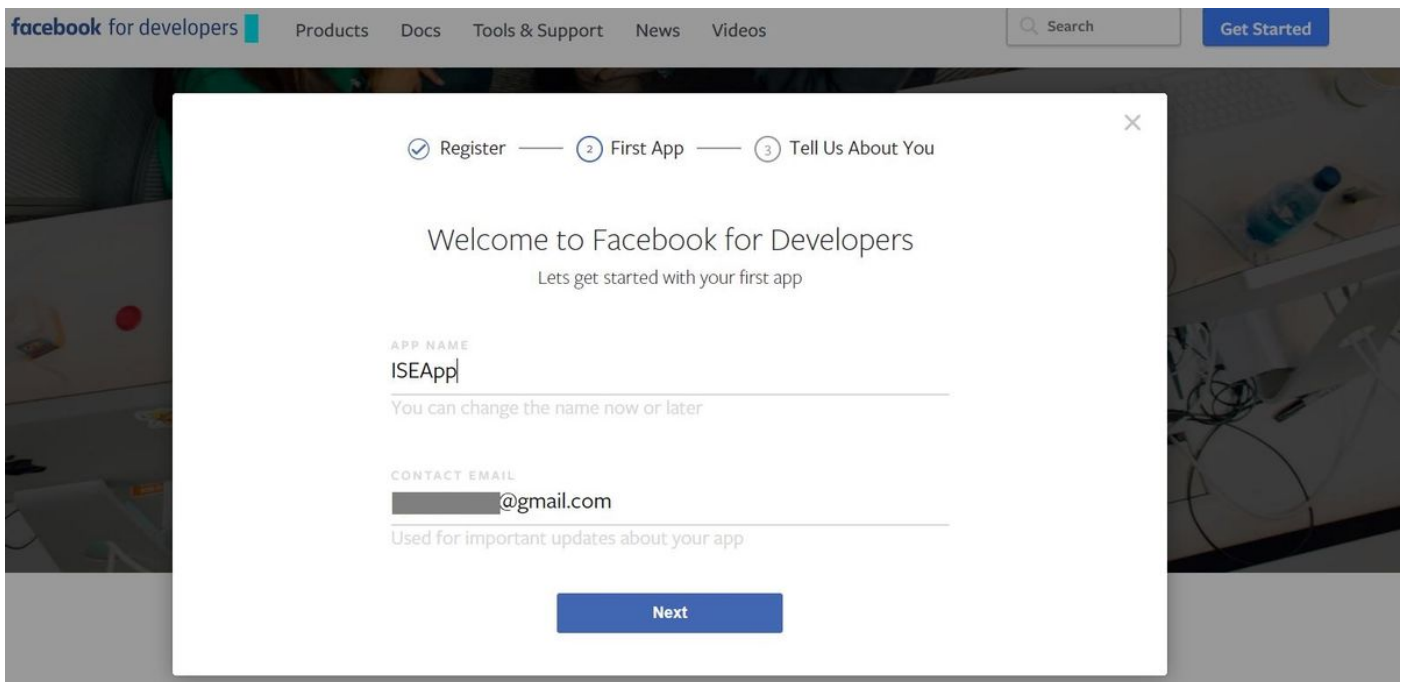

O painel do aplicativo mostra a **ID do aplicativo** e a **chave do segredo do aplicativo**, que serão usadas no ISE para criar o login social externo.

Secure | https://developers.facebook.com/apps/62096[redacted]/dashboard/

ISEApp | APP ID: 62096[redacted] | View Analytics | Tools & Support | Docs

Dashboard

Click to see analytics for this app. X

**ISEApp** 

This app is in development mode and can only be used by app admins, developers and testers [?]

API Version [?] v2.10 | App ID 62096[redacted]

App Secret [redacted] [Show](#)

 **Get Started with the Facebook SDK** [Choose Platform](#)

Use our quick start guides to set up the Facebook SDK for your iOS or Android app, Facebook Web Game or website.

Torne público o aplicativo criado.

Secure | https://developers.facebook.com/apps/62096[redacted]/review-status/

ISEApp | APP ID: 62096[redacted] | View Analytics | Tools & Support | Docs

Dashboard

Settings

Roles

Alerts

**App Review**

PRODUCTS

+ Add Product

**Make ISEApp public?**

**Yes** Your app is currently **live** and available to the public.

**Submit Items for Approval**

Some Facebook integrations require approval before public usage. Before submitting your app for review, please consult our [Platform Policy and Review Guidelines](#). [Start a Submission](#)

**Approved Items** [?]

LOGIN PERMISSIONS

## 2. Integrar o ISE ao aplicativo do Facebook

Use as informações mencionadas abaixo para integrar o aplicativo Facebook ao Cisco ISE.

Navegue até **Administration > Identity Management > External Identity Sources > Social Login** e adicione um novo armazenamento.

**External Identity Sources**

- Certificate Authentication Profile
- Active Directory
  - AD
  - LDAP
  - ODBC
  - RADIUS Token
  - RSA SecurID
  - SAML Id Providers
  - Social Login

Social Login > New

**Social Login**

Name \* FacebookApp

Description

Type \* Facebook

App ID \* 62096

App Secret \*  Show

Cancel Submit

Configure o Portal de Convidado do ISE para Permitir login social.

Identity Services Engine Home Context Visibility Operations Policy Administration Work Centers License Warning

Network Access Guest Access TrustSec BYOD Profiler Posture Device Administration PassiveID

Overview Identities Identity Groups Ext Id Sources Administration Network Devices Portals & Components Manage Accounts Policy Elements Policy Sets Reports Custom Portal Files

Guest Portals

Guest Types Sponsor Groups Sponsor Portals

### Portals Settings and Customization

Portal Name: \* Self-Registered Guest Portal (default) Description: Guests are allowed to create their own accounts and access the network us Portal test URL

Save Close

Language File

#### Portal Behavior and Flow Settings

Use these settings to specify the guest experience for this portal.

#### Portal Page Customization

Customize portal pages by applying a theme and specifying field names and messages displayed to users.

#### Portal & Page Settings

#### Guest Flow (Based on settings)

#### Portal Settings

#### Login Page Settings

Require an access code:

Maximum failed login attempts before rate limiting:  (1 - 999)

Time between login attempts when rate limiting:  minutes (1 - 3000)

Include an AUP as link

Require acceptance

Allow guests to create their own accounts

Allow social login

Show Registration form after social login (i)

Allow guests to change password after login (i)

Allow the following identity-provider guest portal to be used for login (i)

There are no guest portals configured to use a SAML Id Provider as the Authentication Method.

#### Registration Form Settings

Assign to guest type:

Configure guest types at:  
Work Centers > Guest Access > Configure > Guest Types

Account valid for:  Days Maximum: 5 DAYS

Require a registration code:

Fields to include	Required
<input checked="" type="checkbox"/> User name (i)	<input type="checkbox"/>
<input checked="" type="checkbox"/> First name	<input type="checkbox"/>
<input checked="" type="checkbox"/> Last name	<input type="checkbox"/>
<input checked="" type="checkbox"/> Email address	<input checked="" type="checkbox"/>

Depois de configurar o Portal de Convidados do ISE para permitir o login social, o login social será preenchido com URLs e precisará ser adicionado às configurações do aplicativo do Facebook, **URLs de redirecionamento OAuth válidos.**

The screenshot shows the Cisco Identity Services Engine (ISE) interface. The top navigation bar includes 'Home', 'Context Visibility', 'Operations', 'Policy', 'Administration', and 'Work Centers'. Below this, a secondary navigation bar lists 'System', 'Identity Management', 'Network Resources', 'Device Portal Management', 'pxGrid Services', 'Feed Service', and 'Threat Centric NAC'. A 'Click here to' button is visible on the right. The main content area is titled 'External Identity Sources' and contains a tree view with categories like 'Certificate Authentication Profile', 'Active Directory', 'Social Login', etc. The 'Social Login' category is selected, showing a configuration form for 'FacebookApp'. The form includes fields for 'Name' (FacebookApp), 'Description', 'Type' (Facebook), 'App ID' (62098...), and 'App Secret' (masked). There are 'Show', 'Cancel', and 'Save' buttons. A 'Portal' dropdown is set to 'Self-Registered Guest Portal (default)'. Below the form, an information icon and text state: 'Add all these automated redirect URLs to the App settings.' A text box contains the following URLs: https://[redacted]:100:8443, https://[redacted]:120:8443, and https://[redacted].a.net:8443.

Adicione o login do Facebook dos produtos e adicione URLs de redirecionamento OAuth válidos.

Os URLs serão gerados automaticamente no ISE após a associação bem-sucedida do portal ISE ao login social externo do Facebook.

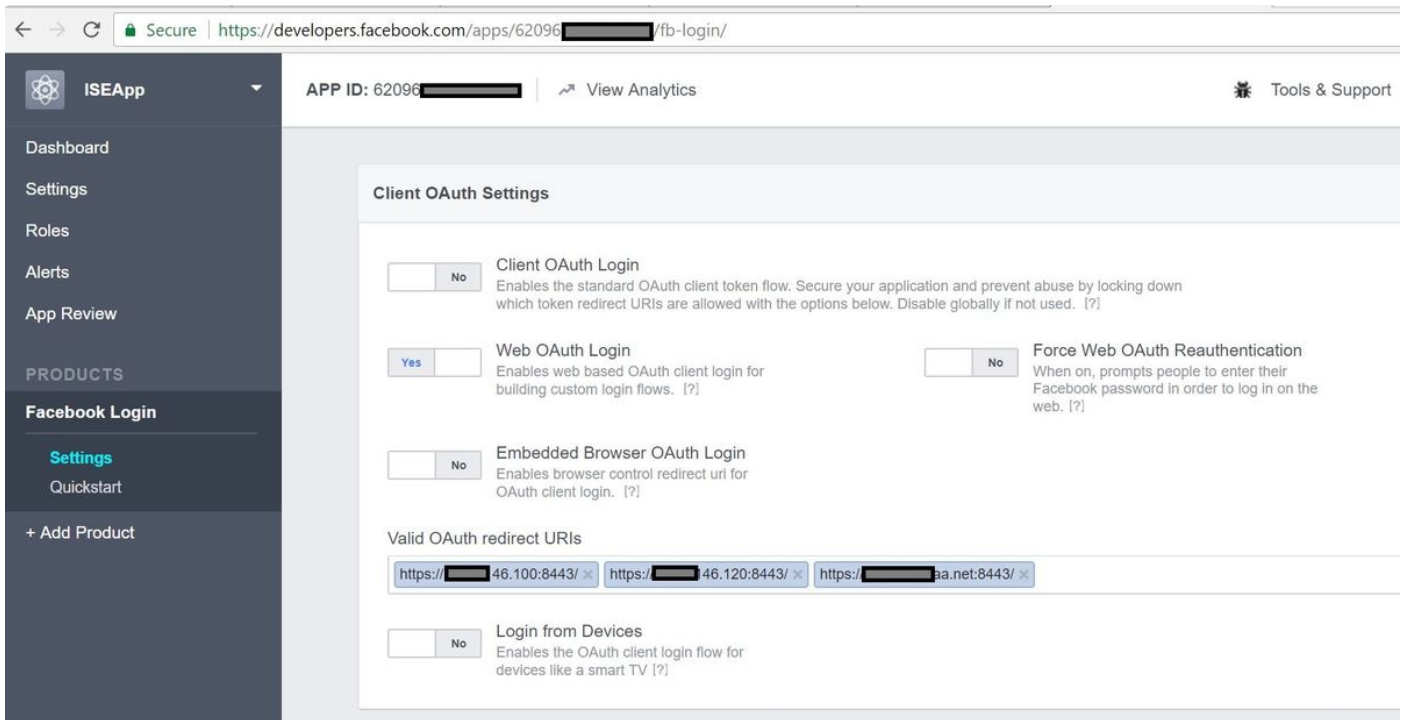

### 3. Configurar políticas de autenticação e autorização

A configuração do ISE segue as mesmas etapas de configuração do Guest CWA (Central Web Authentication).

(Para ver as etapas de configuração do ISE CWA, consulte o documento abaixo:

<https://www.cisco.com/c/en/us/support/docs/security/identity-services-engine/115732-central-web-auth-00.html>)

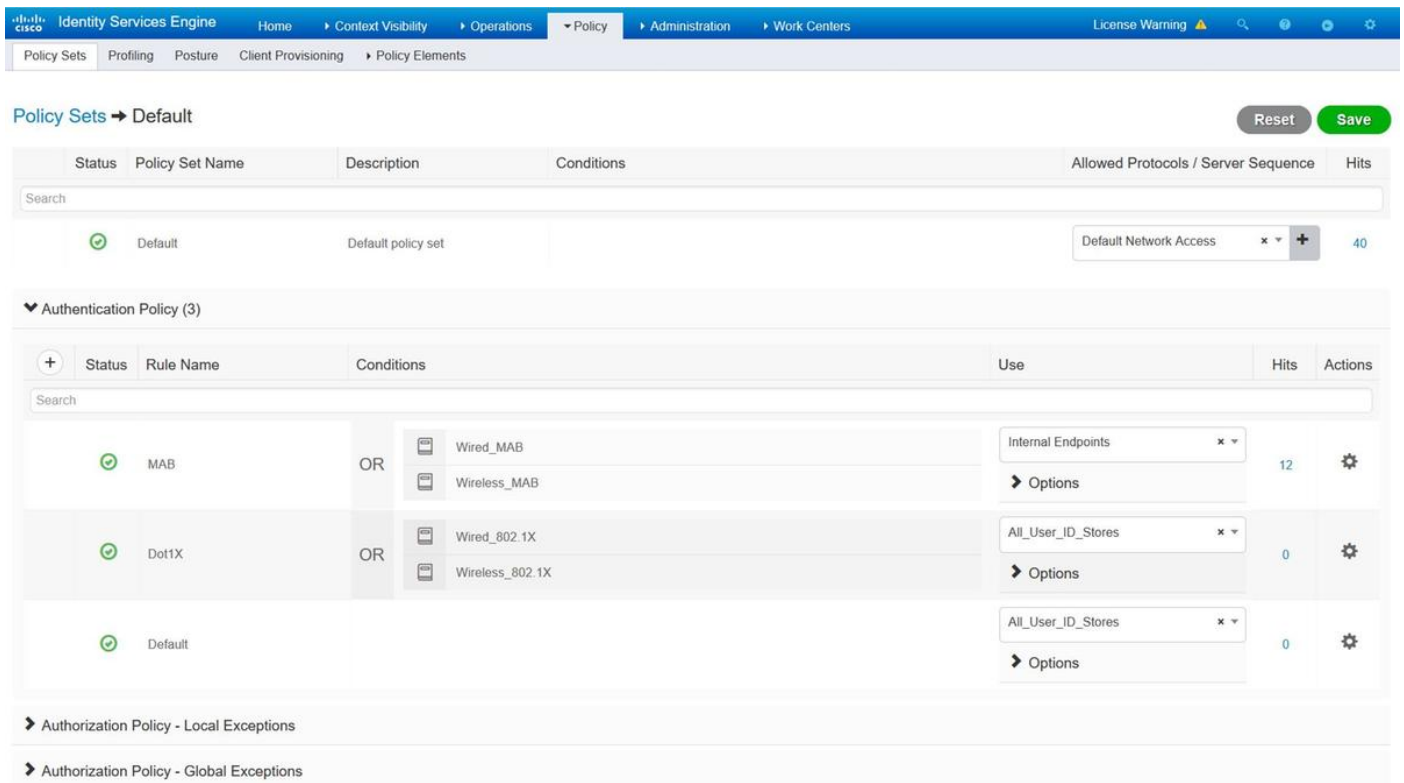

Identity Services Engine Home > Context Visibility > Operations > Policy > Administration > Work Centers License Warning

Policy Sets Profiling Posture Client Provisioning > Policy Elements

Search

Default All\_User\_ID\_Stores 0 Options

Authorization Policy - Local Exceptions

Authorization Policy - Global Exceptions

Authorization Policy (12)

Status	Rule Name	Conditions	Profiles	Security Groups	Hits	Actions
Wi-Fi_Guest_Access	AND	Guest_Flow Wireless_MAB	PermitAccess	Guests	5	
Wi-Fi_Redirect_to_Guest_Login		Wireless_MAB	Cisco_WebAuth_Wireless	Select from list	12	

Verifique se o intervalo de endereços ip do Facebook (31.13.0.0/16) está excluído da ACL de redirecionamento da WLC

MONITOR WLANs CONTROLLER WIRELESS SECURITY MANAGEMENT COMMANDS HELP FEEDBACK Save Configuration Ping

Security

AAA  
General  
RADIUS  
Authentication  
Accounting  
Fallback  
DNS  
Downloaded AVP  
TACACS+  
LDAP  
Local Net Users  
MAC Filtering  
Disabled Clients  
User Login Policies  
AP Policies  
Password Policies  
Local EAP  
Advanced EAP  
Priority Order  
Certificate  
Access Control Lists  
Access Control Lists  
CPU Access Control Lists  
FlexConnect ACLs  
Layer2 ACLs  
Wireless Protection Policies  
Web Auth  
TrustSec SXP  
Local Policies  
Advanced

Access Control Lists > Edit

General

Access List Name Redirect-ACL

Deny Counters 0

Seq	Action	Source IP/Mask	Destination IP/Mask	Protocol	Source Port	Dest Port	DSCP	Direction	Number of Hits
1	Permit	0.0.0.0 / 0.0.0.0	0.0.0.0 / 0.0.0.0	UDP	Any	Any	Any	Any	2391
2	Permit	0.0.0.0 / 0.0.0.0	0.0.0.0 / 0.0.0.0	ICMP	Any	Any	Any	Any	161
3	Permit	0.0.0.0 / 0.0.0.0	0.0.0.0 / 255.255.0.0	Any	Any	Any	Any	Any	1360
4	Permit	0.0.0.0 / 255.255.0.0	0.0.0.0 / 0.0.0.0	Any	Any	Any	Any	Any	1884
5	Permit	0.0.0.0 / 0.0.0.0	31.13.0.0 / 255.255.0.0	Any	Any	Any	Any	Any	708
6	Permit	31.13.0.0 / 255.255.0.0	0.0.0.0 / 0.0.0.0	Any	Any	Any	Any	Any	844
7	Deny	0.0.0.0 / 0.0.0.0	0.0.0.0 / 0.0.0.0	Any	Any	Any	Any	Any	7424

## Verificar

Quando o usuário convidado é redirecionado, ele é apresentado com a opção Fazer login com o Facebook.





### Welcome

Welcome to the Guest Portal. Sign on with the username and password provided to you.

Username:

Password:

[Please read the terms and conditions.](#)

I agree to the terms and conditions

Sign On

OR

 Log in With Facebook

[Don't have an account?](#)

Esse botão tira proveito do aplicativo recém-criado e redireciona para a página de login do facebook, onde o usuário digitará suas credenciais do facebook.

facebook

Sign Up

Log into Facebook

Log In

or

Create New Account

[Forgot account?](#)

[Not now](#)

Após a autenticação bem-sucedida, o usuário convidado redireciona de volta para o Portal do ISE.



**Welcome Message**

Click **Continue** to connect to the network.  
You're very close to gaining network access.

Continue

### Logs ao vivo do ISE Radius:

Identity Services Engine Home Context Visibility Operations Policy Administration Work Centers License Warning

RADIUS Threat-Centric NAC Live Logs TACACS Troubleshoot Adaptive Network Control Reports

Live Logs Live Sessions

Misconfigured Supplicants 0 Misconfigured Network Devices 0 RADIUS Drops 0 Client Stopped Responding 0 Repeat Counter 0

Refresh Every 1 minute Show Latest 100 records Within Last 24 hours

Refresh Reset Repeat Counts Export To Filter

Time	Status	Details	Repeat ...	Identity	Endpoint ID	Posture St...	Endpoint Profile	Authenticat...	Authorization Policy
Aug 21, 2017 10:04:06.404 AM			0	Ulugbek Yusubaliev	E4.A4.71.85.FB.6A		Windows10-Workstation	Default	Default >> Wi-Fi_GuestT_Ac
Aug 21, 2017 10:04:06.397 AM				Ulugbek Yusubaliev	E4.A4.71.85.FB.6A		Windows10-Workstation	Default	Default >> Wi-Fi_GuestT_Ac
Aug 21, 2017 10:04:06.385 AM					E4.A4.71.85.FB.6A				
Aug 21, 2017 10:04:05.766 AM				Ulugbek Yusubaliev	E4.A4.71.85.FB.6A				
Aug 21, 2017 10:01:07.080 AM				E4.A4.71.85.FB.6A	E4.A4.71.85.FB.6A		Intel-Device	Default >> M...	Default >> Wi-Fi_Redirect_
Aug 21, 2017 09:59:59.321 AM				E4.A4.71.85.FB.6A	E4.A4.71.85.FB.6A		Intel-Device	Default >> M...	Default >> Wi-Fi_Redirect_
Aug 21, 2017 09:59:59.302 AM					E4.A4.71.85.FB.6A				
Aug 21, 2017 09:59:49.261 AM				E4.A4.71.85.FB.6A	E4.A4.71.85.FB.6A			Default >> M...	Default >> Wi-Fi_Redirect_

## Overview

Event	5236 Authorize-Only succeeded
Username	Ulugbek Yusubaliev
Endpoint Id	E4:A4:71:85:FB:6A ⓘ
Endpoint Profile	Windows10-Workstation
Authentication Policy	Default
Authorization Policy	Default >> Wi-Fi_Guest_Access
Authorization Result	Guests_PermitAccess

## Authentication Details

Source Timestamp	2017-08-21 10:04:06.395
Received Timestamp	2017-08-21 10:04:06.397
Policy Server	ISE23
Event	5236 Authorize-Only succeeded
Username	Ulugbek Yusubaliev
User Type	GuestUser
Endpoint Id	E4:A4:71:85:FB:6A
Calling Station Id	e4-a4-71-85-fb-6a
Endpoint Profile	Windows10-Workstation
Authentication Identity Store	<u>FacebookApp</u>
Identity Group	GuestEndpoints
Audit Session Id	0e249a0500000007599af5b2
Authentication Method	Authorize Only
Service Type	Authorize Only
Network Device	WLC

## Troubleshoot

## Depurações no ISE

Para habilitar depurações no ISE, navegue para **Administration > System > Logging > Debug Log Configuration**, selecione o nó PSN e altere o nível de log dos seguintes componentes para **DEBUG**:

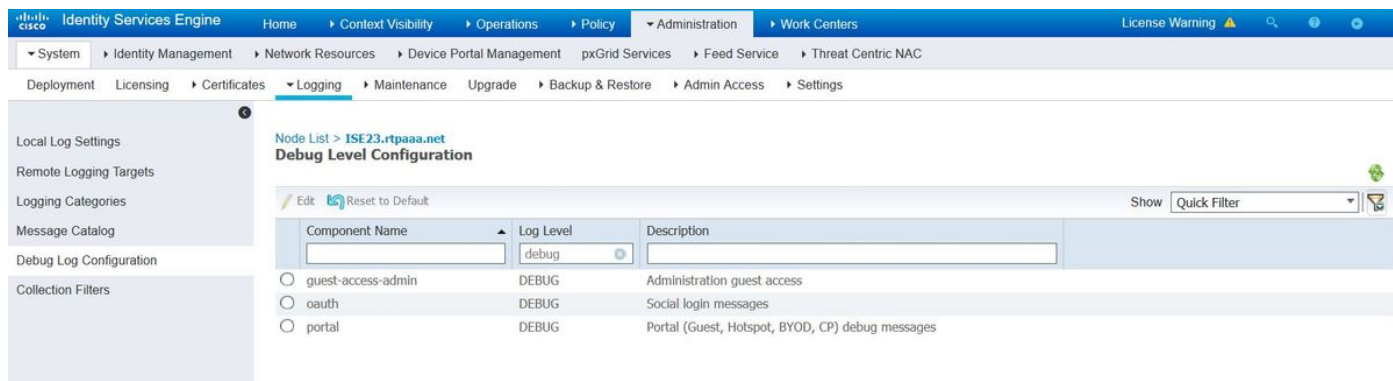

The screenshot shows the Cisco Identity Services Engine (ISE) web interface. The navigation path is Administration > System > Logging > Debug Log Configuration. The page title is "Node List > ISE23.rtpaaa.net Debug Level Configuration". There are buttons for "Edit" and "Reset to Default". A "Show Quick Filter" dropdown is visible. The main content is a table with the following data:

Component Name	Log Level	Description
<input type="radio"/> guest-access-admin	DEBUG	Administration guest access
<input type="radio"/> oauth	DEBUG	Social login messages
<input type="radio"/> portal	DEBUG	Portal (Guest, Hotspot, BYOD, CP) debug messages

Registros a serem verificados - ise-psc.log e guest.log. Você pode segui-los diretamente da CLI do ISE:

```
ise23-1/admin# show logging application ise-psc.log tail
```

Durante a conexão com o aplicativo Facebook, o ISE mostra o erro de tempo limite da conexão:

```
2017-08-21 08:28:18,003 DEBUG [admin-http-pool22][] com.cisco.cpm.oauth.OAuthClient -::::- Got error while checking OAuth settings for AppId: [123456789] and secret key: ****
2017-08-21 08:28:18,003 ERROR [admin-http-pool22][]
admin.restui.features.social.SocialLoginUIApi -::::- ERROR
connect timed out
```

Verifique se o nó ISE tem uma conexão direta com a Internet.

Usando o proxy endereçado no bug [CSCve87511](#) "Suporte de login social com servidor proxy"